

**SPECIFICATIONS**  
 OPERATING INPUT VOLTAGE 12 TO 24 VDC  
 CURRENT DRAW LED/RELAY ON 140 mA @ 24 VDC  
 RELAY CONTACT RATING 2A @ 30 VDC  
 OPERATING TEMP -31F TO 151F  
 OPERATING HUMIDITY 0 TO 85% (Non-Condensing)

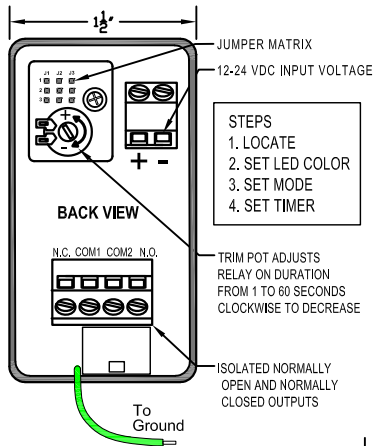

- STEPS**
1. LOCATE
  2. SET LED COLOR
  3. SET MODE
  4. SET TIMER

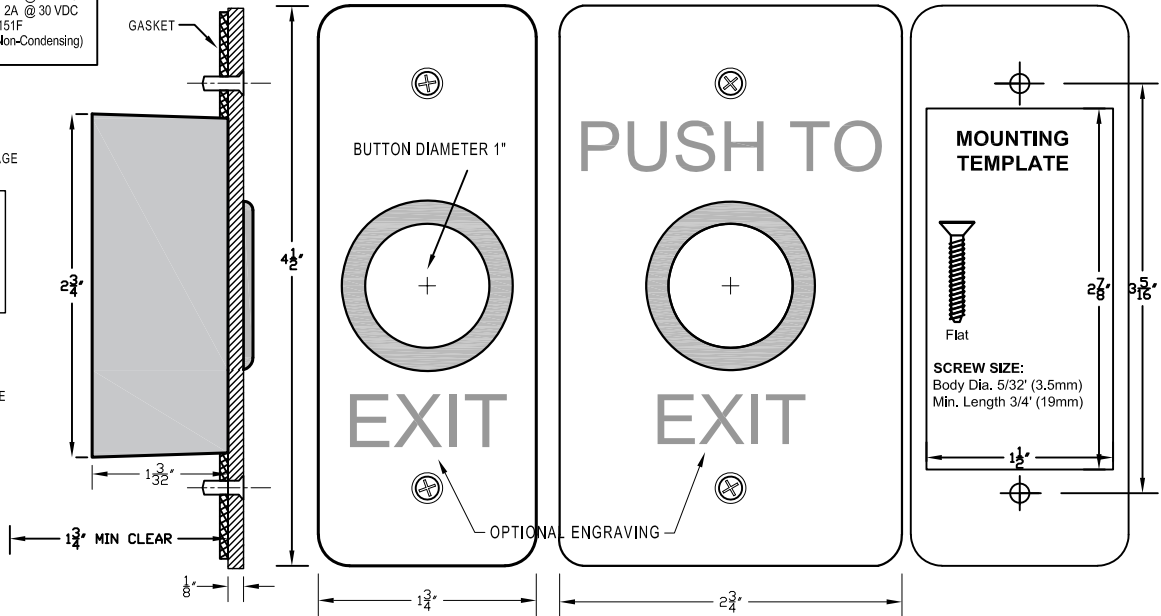
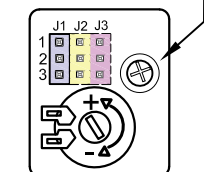

**TABLE 1: LED JUMPER SETTINGS**

REMOVE SCREW & COVER TO ACCESS

SETTING THE RELAY CONTROLLED LED COLOR - J1 AND J3

	JUMPER J1	JUMPER J3	IDLE	ACTIVE
	*NO JUMPER	CONNECT 1-2	OFF	GREEN
	*NO JUMPER	CONNECT 2-3	GREEN	OFF
	CONNECT 1-2	*NO JUMPER	OFF	RED
	<b>CONNECT 1-2</b>	<b>CONNECT 2-3</b>	<b>GREEN</b>	<b>RED</b>
<b>DEFAULT</b>	CONNECT 2-3	*NO JUMPER	RED	OFF
	CONNECT 2-3	CONNECT 1-2	RED	GREEN
	NO JUMPER	NO JUMPER	OFF	OFF



SET THE OPERATING MODE

**JUMPER J2 SETTINGS**

PINS 1 & 2 = TOGGLE

PINS 2 & 3 = TIME DELAY

MOUNT WITH 2 SCREWS PROVIDED TO SINGLE GANG, UL LISTED/RECOGNIZED ELECTRICAL BACK-BOX.

REMOTE ACTIVATION OF LED - OVERRIDES SWITCH ACTION

GROUND CENTER PIN (2) OF J1 FOR RED

GROUND CENTER PIN (2) OF J3 FOR GREEN

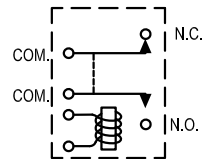

5277 PIEZO SWITCH - RELAY